

**FLAT ROOF** TOTAL FLAT  
ROOF SOLUTIONS

# Thermal Ply

FR/TP

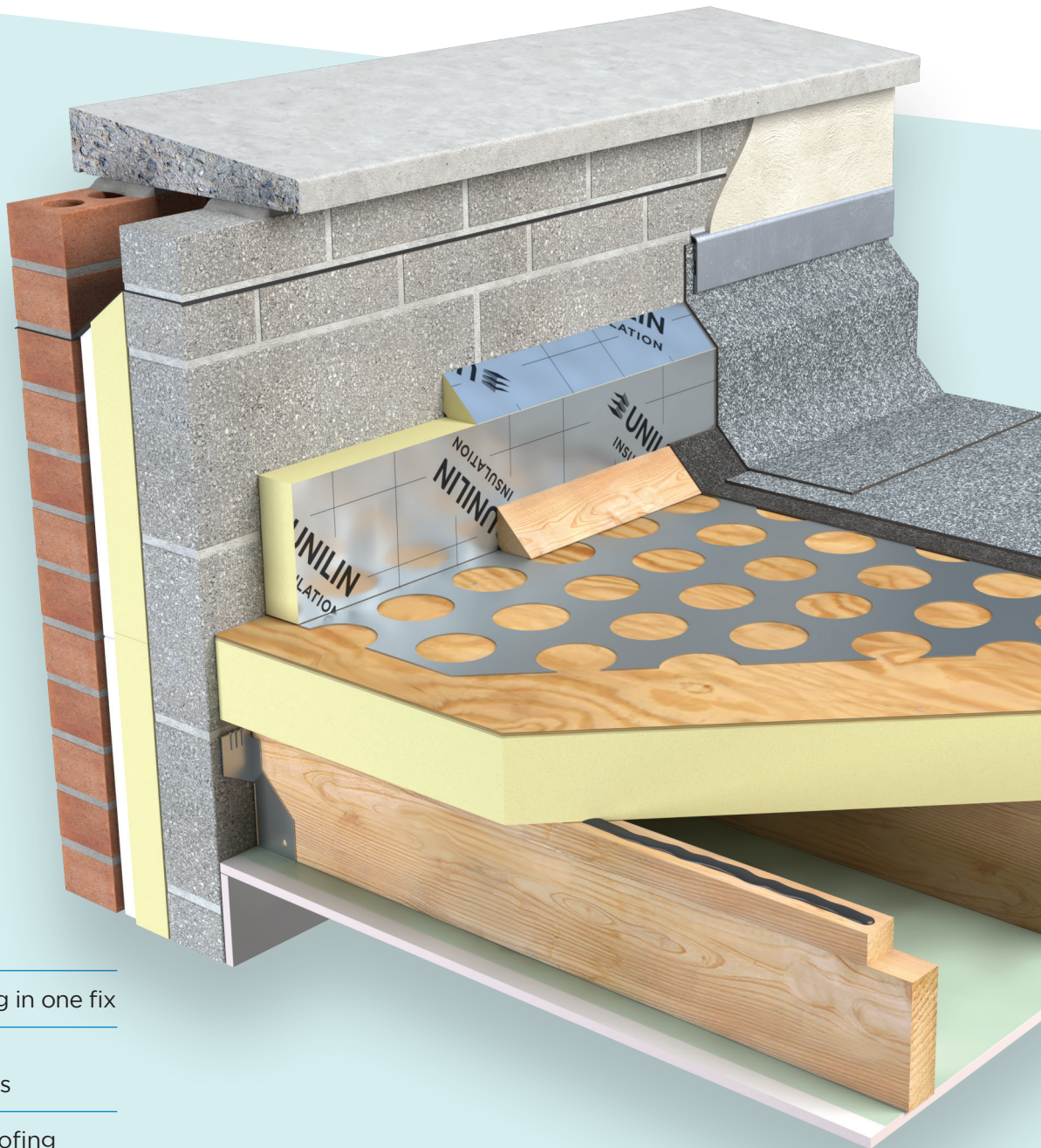

## Insulation & decking in one fix

For new & refurbishment roofs

## Rapid weather proofing



# FLAT ROOF TOTAL FLAT ROOF SOLUTIONS

## Thermal Ply High Performance PIR and Plywood Composite

### FR/TP

**Flat Roof Thermal Ply** is a composite insulated panel of Unilin Polyisocyanurate core with a composite foil face, bonded to 6mm WBP grade plywood. It is designed to provide high levels of thermal insulation and decking in one operation for new and refurbishment of flat roof applications.

#### Benefits

- Insulation & decking in one fix
- For new & refurbishment roofs
- Rapid weather proofing
- An Environmental Product Declaration (EPD), certified by IGBC is available for this product. Please contact technical support for further details.



#### Roof Design

Consideration should be given to the recommendations of BS 4841: Part 3 and the certification of the chosen membrane manufacturer.

#### Falls

The fall on a flat roof should be constant and steep enough to ensure that rainfall does not pond.

#### Fire Performance

The fire rating, when tested to EN 13501-5 and BS 476 Part 3 'External Fire Exposure Roof Test', will be dependent upon the waterproofing system.

#### Specification Clause

The flat roof insulation shall be Unilin Insulation Thin-R FR-TP manufactured to EN 13165 by Unilin Insulation, comprising a rigid Polyisocyanurate (PIR) core between low emissivity foil facings bonded onto 6mm WBP Plywood. To be installed in accordance with instructions issued by Unilin Insulation.

Refer to NBS clause J41 10, J41 420, J21 420, J21 10, J21 5.



1. Unilin Thermal Ply is faced to the under side with a gas-tight foil facer, bedding the panel onto a bed of mastic creates a continuous vapour control layer.
2. It provides a high level of thermal insulation and decking in one application.
3. A second layer may be added between the joists to increase the thermal performance of the roof or to allow a reduction in the thickness of material over the joists. If using insulation between joists the VCL should be placed to the underside of the joists. The insulation layer between the joists must be kept tight to the underside of the deck/insulation above.

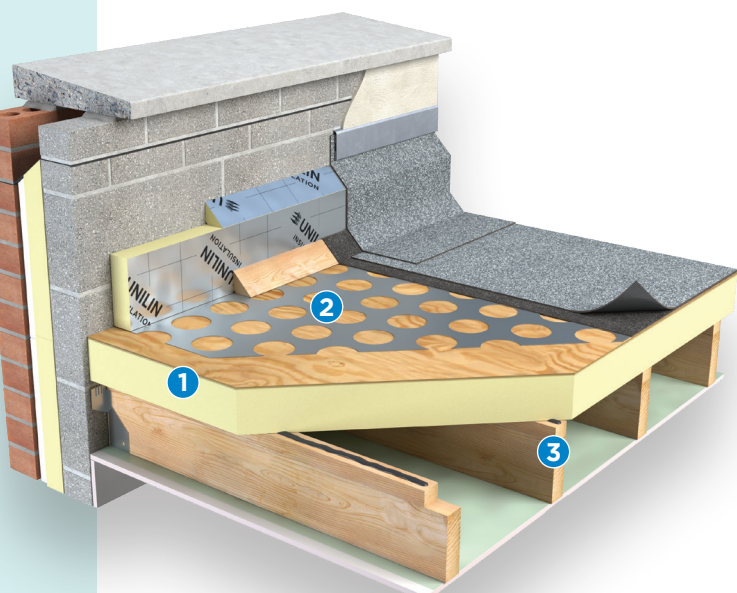

## FR/TP

A warm roof application with all the insulation above the joists is considered best practice. Where insulation between the joists is required to reduce the overall height please note the insulation above the deck should have a higher thermal resistance than that of the insulation between the joists. Contact the Unilin Insulation technical team for further guidance.

The boards should be fixed to a minimum of 50mm thick joists at 600mm centres max with the plywood uppermost.

Boards should be staggered and butted. Each edge should have a minimum bearing of 20mm on joist.

All edges should be supported - add noggings where necessary. Stagger fixings where boards are butted.

Boards should be embedded in vapour resistant mastic to provide a vapour control layer in conjunction with foil facing.

Mastic should be laid wide enough to facilitate 2 panel edges and be continuous around all edges.

The boards should be fixed with low profile screw fixings, placed at 200mm centres around the perimeter of the boards and at 300mm centres along any intermediate supports.

All fixings should penetrate the joists by a minimum of 35mm and be placed 12mm from the edge of the insulation, and no further than 50mm from any corners.

Care should be taken to ensure that the heads of any fixings are flush with the plywood surface and not over-driven.

The roof should be fire protected to the underside by applying a layer of plasterboard or other approved material.

Thermal Ply is suitable for maintenance traffic loadings only.

## FR/TP

<b>Length (mm)</b>	2400
<b>Width (mm)</b>	1200
<b>Thickness* (mm)</b>	56, 76, 86, 96, 106, 116

\*Thickness includes 6mm plywood

## Property & Units

<b>Density (Foam Core)</b>	32 kg/m <sup>3</sup>
<b>Compressive Strength</b>	>150kPa@10% Compression
<b>Thermal Conductivity</b>	0.022 W/mK

## Typical U-Values

Construction	Thickness (mm)	U-Value (W/m <sup>2</sup> K)
Timber deck	146mm*	0.15
Timber deck	116mm*	0.18
Timber deck	106mm*	0.20

\*6mm plywood included in thickness  
Installed over joists and plasterboard below - all edges supported.

The given U-Values are indicative only. Default fixings have been used to calculate the U-Value. For comprehensive calculations on all deck types, please contact Unilin Technical Support.



## HANDLING, CUTTING & STORAGE

Unilin insulation should be stored off the ground, on a clean, flat surface and must be stored under cover. The polythene wrapping is not considered adequate protection for outside exposure. Care should be taken to protect the insulation in storage and during the build process.

The insulation boards can be readily cut using a sharp knife or fine toothed saw. Ensure tight fitting of the insulation boards to achieve continuity of insulation as asked for within the ACDs. Appropriate PPE should be worn when handling insulation. Please refer to Health & Safety data sheets on our website.

The boards are wrapped in polythene packs and each pack is labelled with details of grade/type, size and number of pieces per pack.

### **Durability**

Unilin Insulation products are stable, rot proof, provide no food value to vermin and will remain effective for the lifetime of the building, dependent on specification and installation. Care should be taken to avoid contact with acids, petrol, alkalis and mineral oil. When contact is made, clean materials in a safe manner before installation.







# Expect more Knowledge

Unilin Insulation, formerly Xtratherm, is one of the UK's largest manufacturers and suppliers of insulation. We have a 20-plus year history of working in partnership with construction professionals to close the gap between design and as-built performance.

Higher standards of fabric performance call for greater adherence to best practice detailing. To achieve this and to 'close the gap' between design and build, we provide a dedicated Technical Team, all qualified to the highest standards of competency in U-Value calculation and condensation risk analysis.

#### Here to support you

- BRE listed Thermal Bridging Detailing
- BRE Trained Modelling
- BBA/TIMSA calculation competent
- Warranted Calculations available
- Immediate technical response
- SAP Qualified
- Insulation systems to deliver real onsite performance

#### Get in touch

T: +44 (0) 371 222 1055 E: [info.ui@unilin.com](mailto:info.ui@unilin.com) [unilininsulation.co.uk](http://unilininsulation.co.uk)

**FREE**  
One-to-one  
advice



**Unilin Insulation UK Ltd**

Park Road, Holmewood  
Chesterfield, Derbyshire  
United Kingdom  
S42 5UY

t. +44 (0) 371 222 1033

e. [info.ui@unilin.com](mailto:info.ui@unilin.com)

[unilininsulation.co.uk](http://unilininsulation.co.uk)

**The Sustainable Solution**

Specifying Unilin Insulation is a real commitment to minimising energy consumption, harmful CO<sub>2</sub> emissions and their impact on the environment. Using our products is one of the most effective ways to reduce energy consumption – in fact, after just eight months the energy they save far outweighs the energy used in their production. In addition, our manufacturing facilities operate to an ISO 14001 certified Environmental Management System.

**Environmental Product Declaration (EPD)**

An Environmental Product Declaration or EPD for a construction product indicates a transparent, robust and credible step in the pursuit and achievement of real sustainability in practice, it is a public declaration of the environmental impacts associated with specified life cycle stages of that product. Unilin EPDs have been independently verified in accordance with EN 15804+A2:2019 and ISO 14025 accounting for stages of the LCA from A1 to A3, with options A4-A5 and modules C1-C4 and D included. The process of creating an EPD allows us to improve performance and reduce resource wastage through improvements in product design and manufacturing efficiency. They play a crucial role in manufacturing and construction and are increasingly asked for by industry.

**EPDs and BREEAM**

BREEAM is primarily trying to encourage designers to take EPDs into consideration when specifying products. BREEAM requires EPDs to be verified by a third-party. For the Mat 02 category, points are awarded based on whether EPDs are generic, manufacturer-specific, or product-specific. Non 3rd party verified EPDs to EN 15804 cannot be accepted. All of Unilin EPDs are externally verified.

**Responsible Sourcing**

Unilin has BES 6001 certification for responsible sourcing. The second BREEAM credit under that category is based on responsibly-sourced materials – at least 80% of the total insulation used in roofs, walls, ground floors and services must meet any of tier levels 1 to 6 in the BREEAM table of certification schemes. Our Environmental Management System is certified under EN ISO 14001, and our raw materials come from companies with similarly certified EMS (copies of all certificates are available for BREEAM assessments). This level of responsible sourcing meets tier level 6 in the BREEAM table.

Good workmanship and appropriate site procedures are necessary to achieve expected thermal and airtightness performance. Installation should be undertaken by professional tradespersons. The example calculations are indicative only, for specific U-Value calculations contact Unilin Insulation Technical Support. Unilin technical literature, Agrément certifications and Declarations of Performance are available for download on the Unilin Insulation website. The information contained in this publication is, to the best of our knowledge, true and accurate at the time of publication but any recommendations or suggestions which may be made are without guarantee since the conditions of use are beyond our control. Updated resources may be available on our websites. All images and content within this publication remain the property of Unilin Insulation.



**ISO 45001** Occupational Health & Safety Management Systems

**ISO 9001** Quality Management Systems

**ISO 14001** Environmental Management Systems